

# SCHWINGMETALL® Dome Mounts

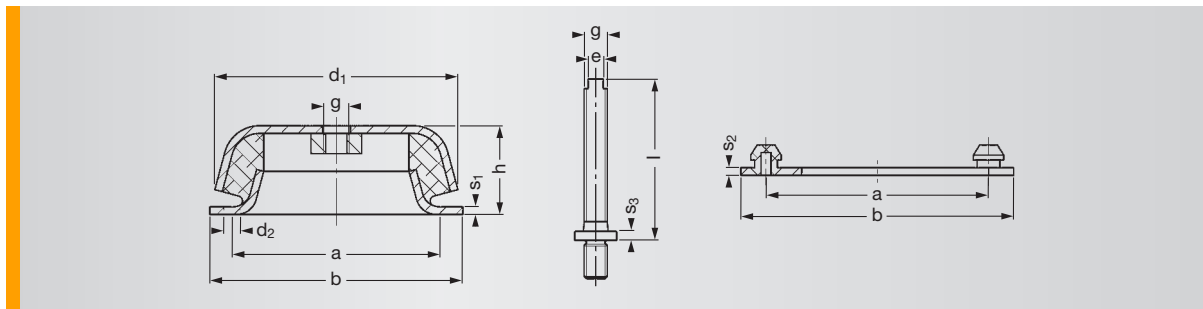
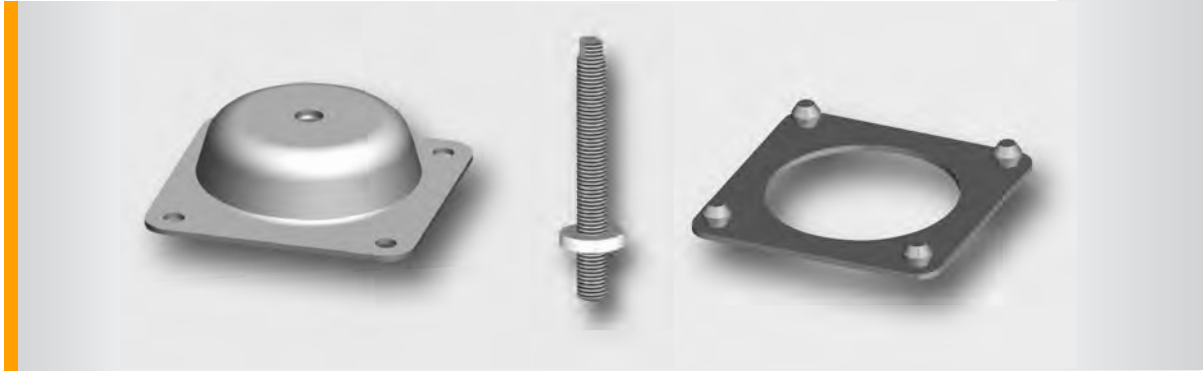

## Dome Mounts 58541

Mould No.	Part No. Mount	Part No. Level Adjustment Spindle	Part No. Washer Mat	Dimensions							
				a [mm]	b [mm]	d1 [mm]	d2 [mm]	e [mm]	g [mm]	h [mm]	s1 [mm]
58541	3956407000	3956027000	3956017000	□ 165	□ 200	192	4 x 13	SW14	M20	70	6
58541	3956207000	3956027000	3956017000	□ 165	□ 200	192	4 x 13	SW14	M20	70	6
58541	3956107000	3956027000	3956017000	□ 165	□ 200	192	4 x 13	SW14	M20	70	6

Mould No.	Part No. Mount	Dimensions			Spring Stiffness			Max. Loads			Mass [kg]	Elas- tomer Hardness [Shore A]
		s2 [mm]	s3 [mm]	Washer DIN 9021-ST	C <sub>x</sub> [N/mm]	C <sub>y</sub> [N/mm]	C <sub>z</sub> [N/mm]	F <sub>x</sub> [N]	F <sub>y</sub> [N]	F <sub>z</sub> [N]		
58541	3956407000	4.0	6	A21x4	1400	1400	1390	4200	4200	7900	4.215	40
58541	3956207000	4.0	6	A21x4	2400	2400	2250	7000	7000	12000	4.215	55
58541	3956107000	4.0	6	A21x4	3450	3450	3400	10350	10350	19700	4.215	65

- ▶ Wet the studs with soapy water before mounting the underlay.
- ▶ Nuts according to DIN 555, washers according to DIN 25 and spring washers according to DIN 127 are commercial parts.